

Fuel Lock off 1311-1011

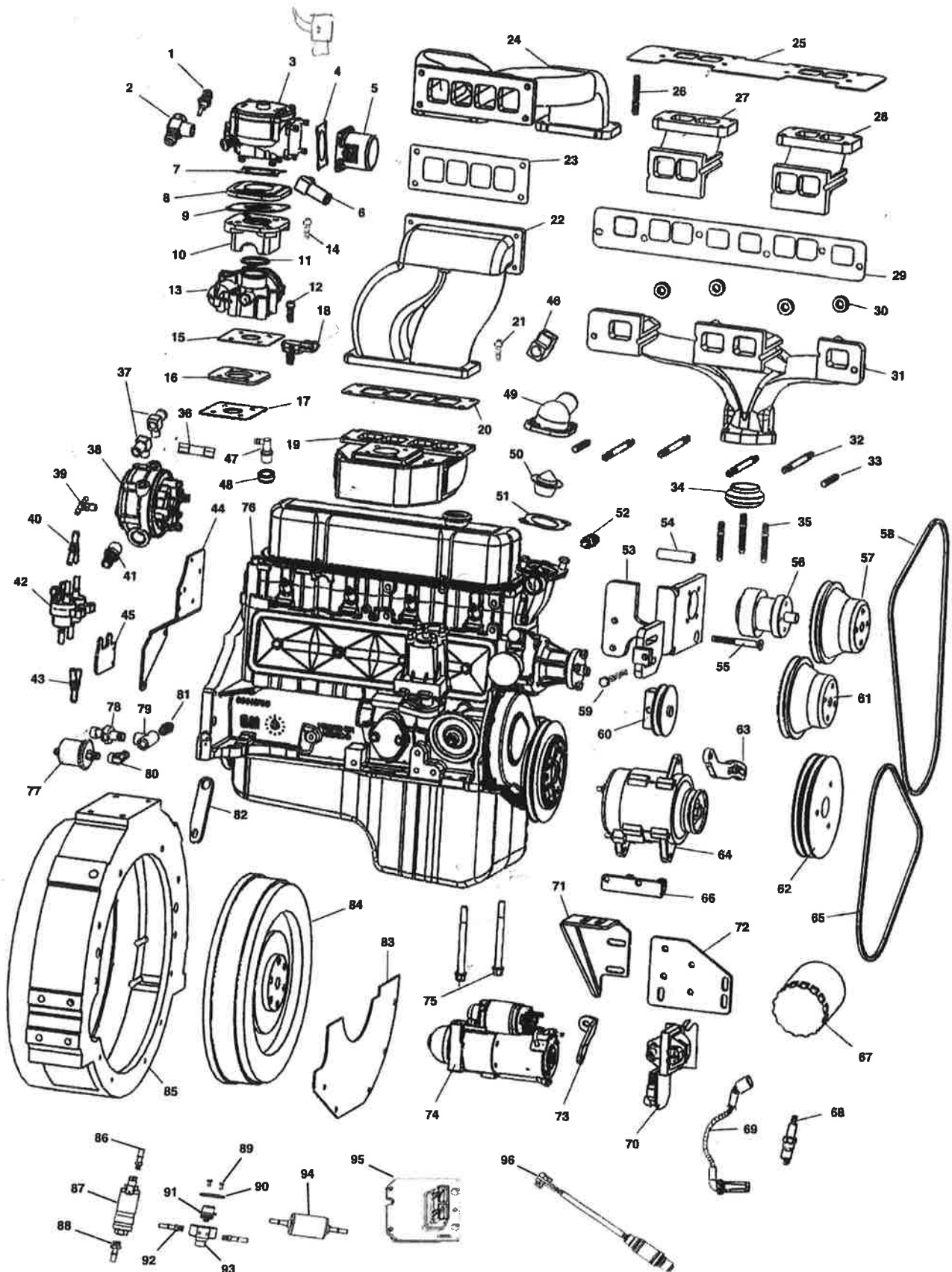

NOTES	DESCRIPTION	YRS	QTY	PART NUMBER
1.	SENSOR, FUEL TEMP	07 - 08	1	1689-1081
2.	FITTING, FUEL INLET (FUEL TEMP SENSOR)	07 - 08	1	PC8130
3.	MIXER, LP (CARBURETOR)	07 - 08	1	8062-1035
4.	GASKET, MIXER AIR INLET	07 - 08	1	N00-5267
5.	INLET, MIXER AIR	07 - 08	1	PC7773
6.	FITTING, CRANKCASE VENT	07 - 08	1	4501-12-06
7.	GASKET, MIXER BASE	07 - 08	1	N00-5204
8.	COVER, MIXER TO THROTTLE BODY ADAPTER	07 - 08	1	PC9085
9.	GASKET, MIXER TO THROTTLE BODY COVER	07 - 08	1	PC9091
10.	ADAPTER, MIXER TO THROTTLE BODY	07 - 08	1	PC9086
11.	O-RING, THROTTLE BODY INLET	07 - 08	1	223-N70
12.	BOLT, THROTTLE BODY (6MMX55MM)	07 - 08	4	M6C55SHCS
13.	THROTTLE BODY	07 - 08	1	6945-5001
14.	BOLT, COVER TO ADAPTER (6MMX35MM)	07 - 08	4	M635HCS82
15.	GASKET, THROTTLE BODY TO SPACER	07 - 08	1	PC9038
16.	PLATE, THROTTLE BODY SPACER	07 - 08	1	PC9067
17.	GASKET, THROTTLE BODY TO INTAKE	07 - 08	1	PC9038
18.	SENSOR, MAP	07 - 08	1	12568929
19.	2 PLENUM, INTAKE MANIFOLD	07 - 08	1	PC9031
20.	2 GASKET, INTAKE MANIFOLD PLENUM	07 - 08	1	PC8170 / <i>gasket</i>
21.	BOLT, INTAKE	07 - 08	AR	BHM05C125
22.	2 RISER, INTAKE MANIFOLD	07 - 08	1	PC9032
23.	2 GASKET, INTAKE MANIFOLD MID-CORE	07 - 08	1	PC8171
24.	2 CROSSOVER, INTAKE MANIFOLD	07 - 08	1	PC9033
25.	2 GASKET, INTAKE MANIFOLD RISER	07 - 08	1	PC9087
26.	STUD	07 - 08	8	ST14
27.	2 TUBE, INTAKE MANIFOLD RISER (RH)	07 - 08	1	PC9034
28.	2 TUBE, INTAKE MANIFOLD RISER (LH)	07 - 08	1	PC9035
29.	2 GASKET, INTAKE/EXHAUST MANIFOLD	07 - 08	1	PC8172
30.	2 WASHER, INTAKE/EXHAUST	07 - 08	4	PC9065
31.	2 MANIFOLD, EXHAUST	07 - 08	1	PC9029

32.	STUD, INTAKE/EXHAUST MANIFOLD (LONG)	07 - 08	4	PC9030-1
33.	STUD, INTAKE/EXHAUST MANIFOLD (SHORT)	07 - 08	2	ST41
34.	SEAL, EXHAUST	07 - 08	1	F17990
35.	STUD, EXHAUST	07 - 08	3	ST41/IND
36.	THERMOSTAT, INLINE	07 - 08	1	N3-0345
37.	FITTING, VAPORIZER COOLANT	07 - 08	2	269HB-10-4
38.	REGULATOR, LPG VAPORIZER	07 - 08	1	5233-1018-6
39.	TEE, VACUUM	07 - 08	1	111-4-2
40.	"Y" VACUUM (BLACK)	07 - 08	1	1295-1073
41.	FITTING, VAPOR HOSE	07 - 08	1	125HBL-12-12
42.	VALVE, FUEL TRIM (DITHER)	07 - 08	2	1309-6019
43.	"Y" VACUUM (WITH ORIFICE) (BLUE)	07 - 08	1	1326-2053
44.	BRACKET, VAPORIZER REGULATOR	07 - 08	1	PC8169
45.	BRACKET, FUEL TRIM VALVE	07 - 08	1	PC8167
46.	FITTING, COOLANT HOSE	07 - 08	1	225P-8
47.	VALVE, PCV	07 - 08	1	3-9229
48.	GROMMET	07 - 08	1	<del>3989346</del> 14091870
49.	HOUSING, THERMOSTAT	07 - 08	1	14096853
50.	THERMOSTAT, ENGINE COOLANT	07 - 08	1	10220957
51.	GASKET, THERMOSTAT HOUSING	07 - 08	1	10105135
52.	SENSOR, COOLANT TEMP.	07 - 08	1	10096181
53.	BRACKET, HIGH MOUNT FAN	07 - 08	1	PC7524
54.	SPACER,	07 - 08	1	PC7529
55.	BOLT,	07 - 08	1	37C350FHSCS
56.	SPINDLE, HIGH MOUNT FAN	07 - 08	1	<del>PC7520</del> PC7250
57.	PULLEY, HIGH MOUNT FAN	07 - 08	1	PC14023155
58.	BELT, ALTERNATOR AND WATER PUMP DRIVE	07 - 08	1	25-7480
59.	BOLT, TENSIONER ADJUSTMENT	07 - 08	1	BHM06C400
60.	PULLEY, BELT TENSIONER	07 - 08	1	PC7525
61.	PULLEY, WATER PUMP	07 - 08	1	PC14023155
62.	PULLEY, CRANKSHAFT	07 - 08	1	PC7600
63.	BRACKET, ALTERNATOR ADJUSTMENT	07 - 08	1	PC8141

64.		ALTERNATOR, 70 AMP	07 - 08	1	KO32049
65.		BELT, ALTERNATOR AND WATER PUMP DRIVE	07 - 08	1	25-7380
66.		BRACKET, ALTERNATOR MOUNT	07 - 08	1	PC8140
67.		FILTER, OIL	07 - 08	1	PF25
68.	1	SPARK PLUG	07 - 08	4	88892834
69.		WIRE, SPARK PLUG KIT	07 - 08	1	PC8269
70.		COIL, IGNITION	07 - 08	1	93804365
71.		BRACKET, INTAKE SUPPORT	07 - 08	1	PC8203
72.		MOUNT, INTAKE SUPPORT	07 - 08	1	PC8202
73.		BRACKET, STARTER SUPPORT	07 - 08	1	PC8124
74.		MOTOR, STARTER	07 - 08	1	9000821
75.		BOLT, STARTER	07 - 08	1	12338064
76.		ENGINE, 3.0L BASE	07 - 08	1	93445927
77.		SENDER, OIL	07 - 08	1	02504-02
78.		SENSOR, OIL	07 - 08	1	12574403
79.		TEE, STEEL 1/8 X 1/8 X 1/8	07 - 08	1	5602-04-04-04
80.		FITTING, OIL SENDER	07 - 08	1	5502-04-02
81.		FITTING, OIL SENSOR	07 - 08	1	5405-2-4
82.		SUPPORT, OIL SENSOR	07 - 08	1	PC7820
83.		PLATE, FLYWHEEL BACKING	07 - 08	1	KM2186
84.		FLYWHEEL, GM 3.0L	07 - 08	1	PC7521
85.		BELLHOUSING, SAE # 3	07 - 08	1	KM7539
86.		FITTING, 3/8-24 UNF X 3/8 QD	07 - 08	1	PC8205
87.		PUMP, FUEL	07 - 08	1	GSL-392k
88.		FITTING, 5/8-18 UNF X 3/8 QD	07 - 08	1	PC8206
89.		SCREW, 1/4-20 X 3/4	07 - 08	2	BHM04C075
90.		RETAINER, FUEL PRESSURE REGULATOR	07 - 08	1	PC7968-1
91.		REGULATOR, FUEL PRESSURE	07 - 08	1	12568878
92.		FITTING, 1/4 NPT X 3/8 QD	07 - 08	1	PC8207
93.		BRACKET, FUEL PRESSURE REGULATOR	07 - 08	1	PC7979
94.		FILTER, GASOLINE FUEL	07 - 08	1	3489
95.	3	SECM48	07 - 08	1	1751-6068

(12-07)

KEM EQUIPMENT PARTS DEPT 503.692.5012

3.0L DUAL FUEL

